



Nordic Pinelodges



Designed specifically for the holiday letting market, our Nordic Pinelodge collection draws on over 30 years' experience of building high quality timber buildings and 15 years as a holiday park operator.

We know that a typical holiday lodge has to withstand up to two changeovers a week, 30 plus weeks a year, so our Nordic range has been designed to be tough enough to withstand this and still look good. All models feature timber interiors, which not only create a holiday atmosphere, but are also very low maintenance, needing no redecoration.







With its simplicity of design and log cabin feel, the Nordic Pinelodge has everything today's holidaymakers aspire to. It's a world away from home yet with all home comforts. Internally, we use only high quality, practical yet stylish lodge components. Everything in the Nordic lodge looks good and works well.

A well constructed, energy efficient building costs less to run and maintain. That's why the component insulation levels in the Nordic lodges are to Building Regulation standards which makes them twice as thermally efficient as BS3632.

Air (and heat) leakage from our lodges has been tested to three times better than regulation building standards. This, combined with a super-efficient A-rated boiler; key fob controlled low energy lighting, water saving taps and showers gives you one of the most truly energy efficient lodges you can buy.





The Nordic lodge is available in a choice of exterior colours to blend or contrast with its environment and offers uncompromising build quality at a competitive price.

Standard models include a cosy one bedroom lodge, through to a spacious four bedroom version for a large or extended family, but our design team are always happy to draw up plans to suit individual requirements.

Colour options available



Cladding: Natural Forest
Trim: Oaken



Cladding: Gregorian Grey
Trim: Wild Thyme



Cladding: Forest Green
Trim: Evergreen



Cladding: Northern Pike
Trim: Carolina Stone

The colours shown are printed as accurately as the printing process will allow.

Samples will be provided on request.



1 Bedroom, 1 Bathroom Lodge
22' x 20' (6.8m x 6.1m)



2 Bedroom, 1 Bathroom Lodge
28' x 20' (8.6m x 6.1m)

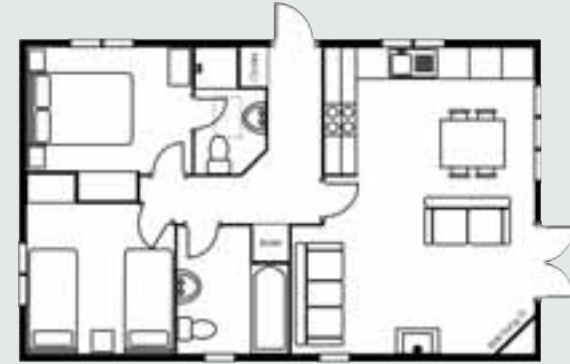

2 Bedroom, 2 Bathroom Lodge
32' x 20' (9.9m x 6.1m)



3 Bedroom, 2 Bathroom Lodge
38' x 20' (11.7m x 6.1m)



4 Bedroom, 2 Bathroom Lodge
47' x 20' (14.4m x 6.1m)



Pinelog Limited, Riverside Business Park,
Bakewell, Derbyshire DE45 1GS
Tel: 01629 814481 Fax: 01629 814634
email: admin@pinelog.co.uk www.pinelog.co.uk